

MX-CD100

KNX Corridor Motion Detector



Features

- MX-CD100 KNX Presence Detector is ideal for corridors and parking buildings. Detector is available in two models; Flush Mounted and Surface Mounted.
- Constant light function can be applied in dependence of presence information thanks to integrated brightness sensor and movement sensor. It regulates the ambient brightness to a defined brightness value.
- Lighting can be set to different brightness levels with corridor function based on occasions such as "motion detection, after movement, no action". Stay-on time can be changed the by end user.
- Air-conditioning and ventilation systems can be controlled by independent HVAC channel.
- The sensor has corridor function feature. Through to this feature presence, absance, stay on time and switch off delay values can be adjustable via KNX. (Corridor function graph)
- Presence information can be sent to presence monitoring applications by independent presence channel.
- The MICROAXS KNX MX-CD100 can either used as a standalone device or master-slave device (parallel operation with other sensors) according to necessity of project.
- MX-CD100 enables fully-automatic and semi-automatic lighting control.
- Test and calibration mode allows for easy installation.
- The device does not require an additional power supply.

MX-CD100

KNX Corridor Motion Detector

Specification

Model	MX-CD100
Supply Voltage	21V... 30V DC, KNX line
Current consumption	≤ 10 mA
Application Area	Indoors, Corridors, Car parks, Warehouses
Sensor Type	Passive infrared
Installation Location	Flush / Surface Mounted
Installation Recommended height	2.5 m – 4.5 m
CD100 Coverage	12x4 m coverage (radial walk)
Additional Channels	Illumination level, movement channel, HVAC ch. Master/Master, Master/Slave
Angle	180° aisle
Light level	10 – 1000 lux
Operating LED (Red) and button	- 5°C +45°C
Parallel operation	Used to program the device
Temperature Operation	-25°C +55°C
Storage	-25°C +70°C
Dimensions	Flush Mounted; (H) = 60 mm x (Ø) = 115 mm Surface Mounted; (H) = 62 mm x (Ø) = 115 mm
Weight	Flush Mounted; 83g Surface Mounted; 97 gr
Ceiling section dimension	Ø 102 mm (4inch)



MX-CD100

KNX Corridor Motion Detector

Corridor function graph

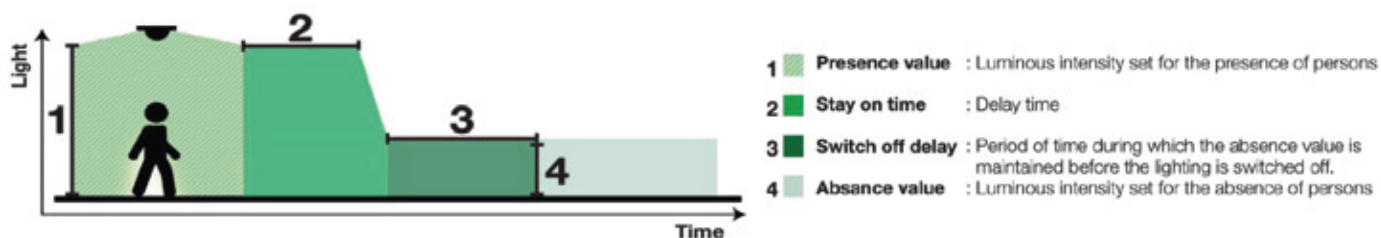

Drawings

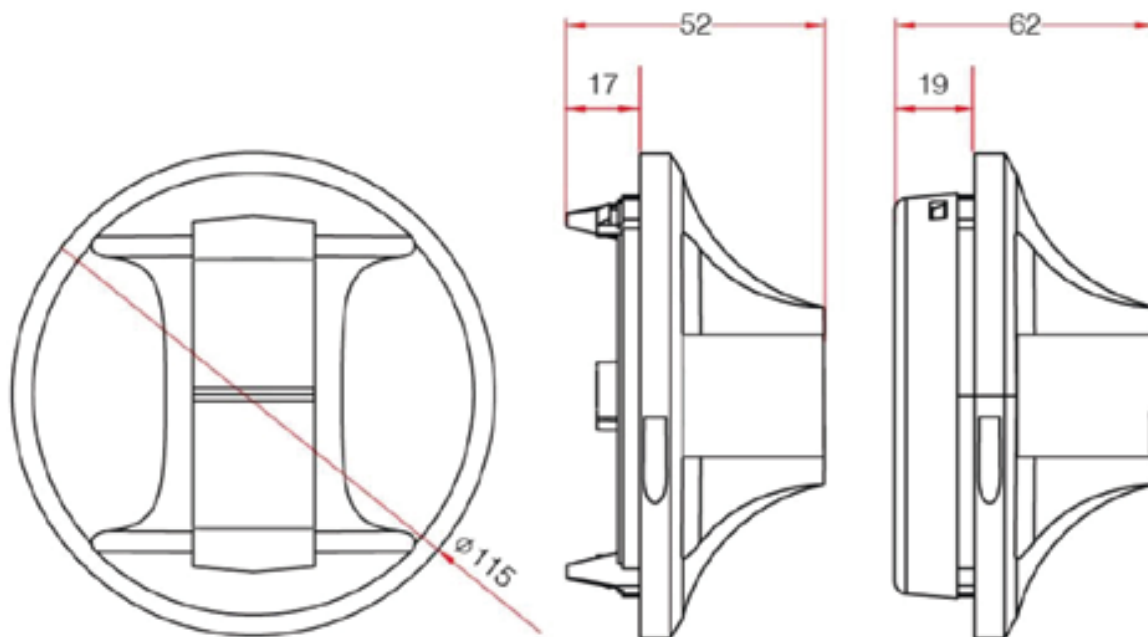

Flush Mounted

Surface Mounted