

The background image shows a modern interior space. On the left, a dark wood-grain door is partially open, revealing a silver handle and a black digital lock panel. The lock panel has a small screen displaying the number "123" and several icons. To the right of the door is a large glass wall that looks out onto a landscape with green bushes and mountains under a blue sky with white clouds. In the foreground, a sleek, black, curved lounge chair is positioned on a light-colored floor. The entire scene is framed by a thin red border.

**SMART
ROOM ACCESS
CATALOG**



SMART LOCKS

MICROAXS provides innovative electronic locking systems, electronic safes, and energy management systems. The smart locks that allows you to open and lock your doors with a virtual key of fingerprint, face, code, RFID card, putting an end to the problem of lost keys and enabling an array of intelligent and useful features. We offer our customers industry-leading solutions, all backed by globally accessible customer service and support.

MICROAXS has accumulated an experience of more than a decade developing, manufacturing and commercializing Electronic Locks, Safes and Minibars. Today, **MICROAXS** is one of the most recognized brands in the HOSPITALITY sector, with a guarantee of quality and service on the 5 continents.

A highly specialized team in all areas and a totally market-oriented focus have made it possible for **MICROAXS SYSTEMS** to develop solutions for security and comfort. By connecting this team with the logistics centers in Europe, America and Asia, today we are able to be present in more than 10,000 hotels around the world, including the most prestigious international hotel chains.

Leaps in quality and specialization do not occur by chance. Recent investments in R+D, guaranteed by our knowledge of the market, have led to **MICROAXS** being at the forefront of the sector today. **MICROAXS** locks and access control for hotels are the result of our company's specialization and orientation in a single direction - the hotel. Today, our name is synonymous with quality, reliability, security and service, with the best quality/cost ratio on the market.



ABOUT US

MICROAXS is a brand of **MICROLINK NETWORKS LLC** with its headquarter in Houston, United States and a family business at a global scale. **MICROAXS** means smart automation with complete features for the control of lights, window shutters, air conditioning, security and audio etc. We constantly develop, innovate high quality new design, efficiency and user experience trends at the same time all solutions are strictly controlled in terms of quality, thus ensuring an outstanding performance.

The Interact promise

Your enterprise and innovation needs are unique. That's why we created dedicated Interact software suites for businesses, cities, and infrastructures.



One Dashboard

One dashboard for all lighting applications, with a common user interface and experience across all software.



Easy Operations

Easy operations and maintenance through remote monitoring, diagnostics, and upgrades.



Robust Security

Integrates with your existing IT security policy and management system for robust security.



Flexible Integration

Integrates and exchanges commands, events, and data with your enterprise software systems.



Actionable Data

Retrieves contextualized data from sensors and other IoT devices connected to the lighting system.



Secure APIs

Offers open, secure APIs plus a developer sandbox through the Interact Developer Portal.



Fully Certified

Guaranteed to work with any luminaire, lamp, or sensor under our certification programs.



Eco-Friendly Products

We consider and have ability to reduce the waste and its effects on the environment.

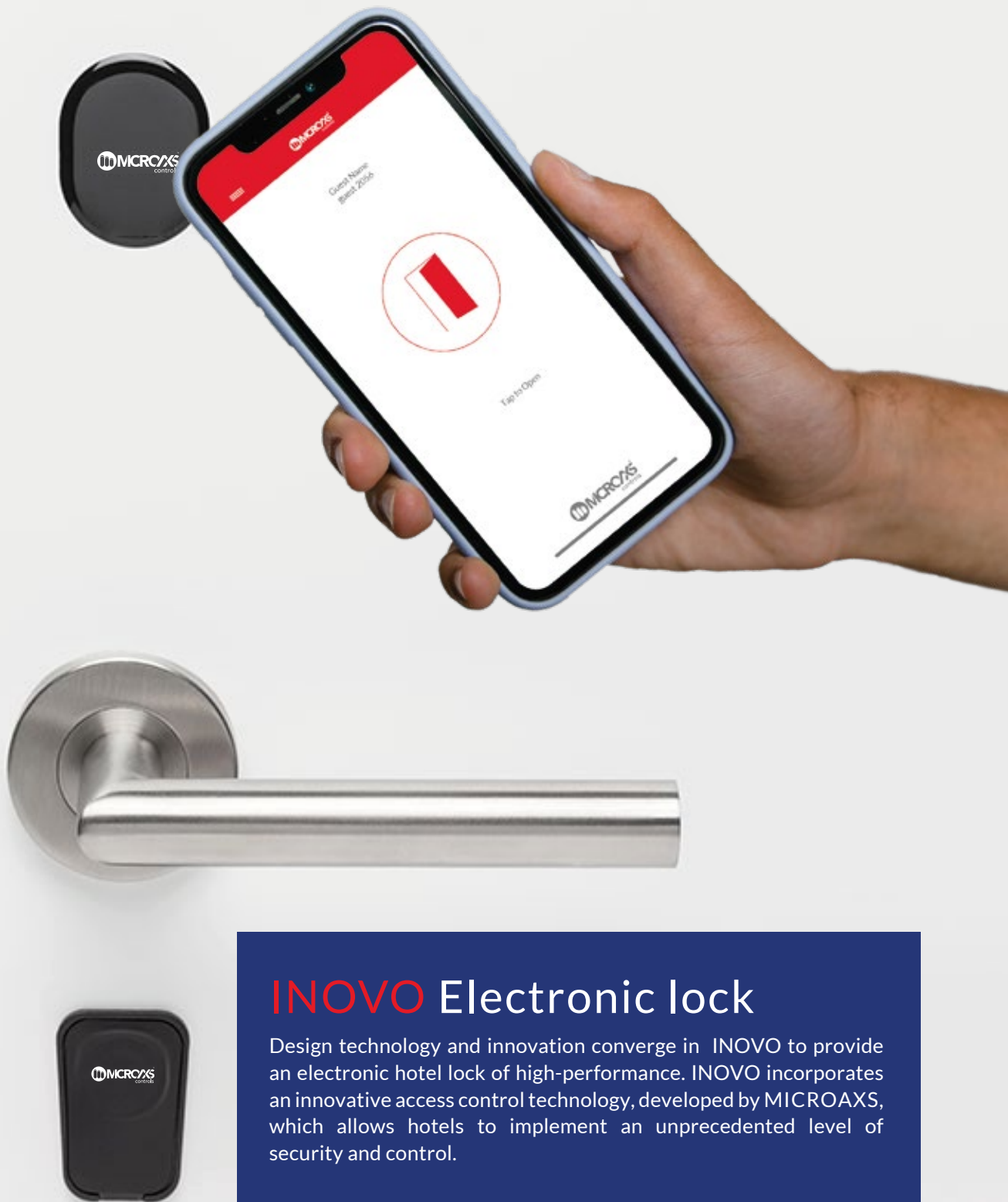

INOVO Electronic lock

Design technology and innovation converge in INOVO to provide an electronic hotel lock of high-performance. INOVO incorporates an innovative access control technology, developed by MICROAXS, which allows hotels to implement an unprecedented level of security and control.

- **Minimalist**, thanks to its avant-garde and innovative design.
- **Customizable Design**, designed for new doors, with a configuration allowing a free choice of handle, with all mechanisms, electronics and batteries located inside the door, a reader and customizable keyholes.
- **Unlimited Audit Trail**, openings, opening attempts, exits, etc. Audit synchronized with the front desk PC.
- **Bluetooth**, for guest openings, setting up, management and maintenance of the lock.
- **On-Line**, remote opening and management by including Gateways in the installation.
- **Control**, installing in a room the INOVO lock, the EXO safe and the Gateway allows remote management and control of both devices.
- **Unlocking record**
3360PCS

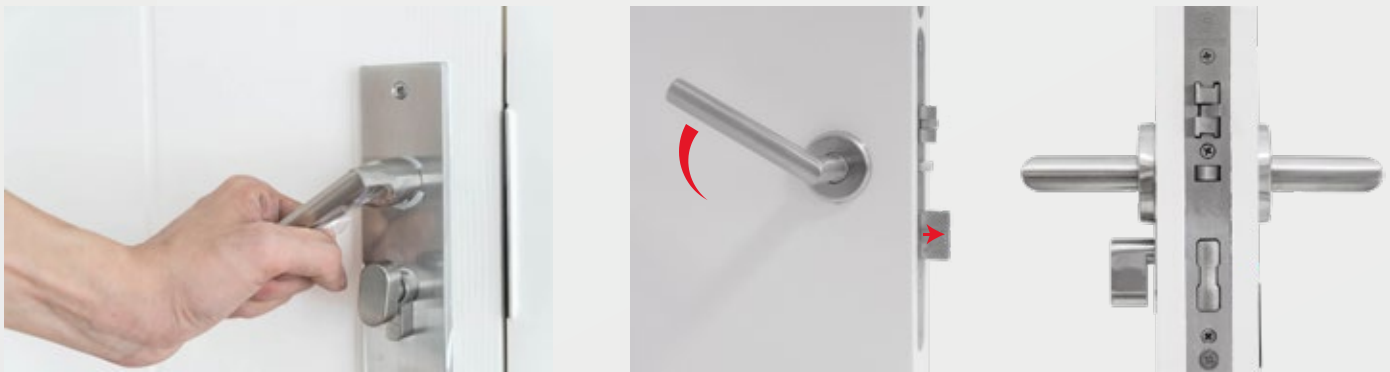

FEATURES

- System of opening with Smartphone via Bluetooth and MIFARE proximity.
- Option to open and manage online by installing Gateways.
- Electronics integrated into the door, without antennas or external connectors exposed to undesired tampering.
- Closing option with a latch and privacy activated by a knob or a reverse turn of the handle:
 - Hotel mode: Closed only from inside the room, using a knob or by reverse turning the handle.
 - ARO (Apartment-Residence-Office) mode: Lets you close the latch and activate privacy from either side of the door by reverse turning the handle.
- Guaranteed operation in the most adverse climatological environments. Stainless steel AISI 304 manufactured. IP 56.
- Visual and acoustic indicators to facilitate their use by disabled persons, as well as for additional functionalities such as low battery warnings to personnel, privacy indicator, etc.
- Mortise with silent latch, anti-card device and anti-panic function.
- Single mortise lock for doors opening in either direction.
- Hidden mechanical cylinder, for auditable emergency openings.
- Single app for administrator, hotel staff and guests. UpKey allows different functionalities according to the registered user profile.
- The guest is automatically logged into the app via a link created by the hotel which the guest receives in an email.
- Customised app option and integration with third parties.





INOVO Configurations

The INOVO smart lock has been developed with three different configuration modes, so it can be used in any location and meet the needs all categories of hotels, the hospitality sector and holiday rentals.

HOTEL

PRIVACY

Privacy with thumb-turn - **Tradition and Style**

Privacy and closing of the latch achieved by turning the knob located on the inside of the door.

Traditional privacy system for hotel locks, without sacrificing the minimalism and intrinsic style of the INOVO lock.

Convenience and simplicity of use for the guest.



REVERSIBLE HANDLE

Privacy with reversible handle - **Extreme Minimalism**

Privacy achieved from inside the room by turning the handle upwards, with a reverse movement to open.

Not having a knob means only the handle is installed inside the room; thus configuring an INOVO lock with extreme minimalism. No part of the lock affects the look of the inside of the door and, therefore, the room.



ARO- Apartments | Residentials | Offices

DOUBLE REVERSIBLE HANDLE

Double privacy - **Design and Security**

Under the A.R.O. Configuration, the INOVO lock lets you have privacy by closing the latch from either side of the door.

Turning the handle up, with a reverse movement to open, closes the latch and gives you privacy, both from inside and outside the door. This functionality ensures the latch is closed when leaving the room, leaving the room properly closed and secure.



INOX



BLACK



GOLD



BRONZE



COPPER



MX-HL11 Smart Lock

The MX-HL11 smart lock stands out for its slim design with narrow escutcheons that give the door and the room a plus of style and elegance.

Its high technological level combined with the opening via Bluetooth, MiFare proximity card and remotely online, through Gateway, make MX-HL11 one of the models with the greatest projection in the hotel sector.



MX-HL11

New smart lock, which will bring more convenience and safety to your life.

FEATURES

- System of opening with Smartphone via Bluetooth and MIFARE proximity.
- Option to open and manage online by installing Gateways.
- Hotel mode: Closed only from inside the room, using a knob or by reverse turning the handle.
- ARO (Apartment-Residence-Office) mode: Lets you close the latch and activate privacy from either side of the door by reverse turning the handle.
- Guaranteed operation in the most adverse climatological environments. Stainless steel AISI 304 manufactured. IP 56.



Model	MX-HL11
Color	Black
Material	Aluminum alloy
RFID Unlock	√
Lifetime	300000
Mechanical Key	√
Power Supply	4*AA alkaline battery
Battery Life	15000 times
Working Temperature	-20~60°C
Working Humidity	20%~95%
Mortise Type	"ANSI standard 5 tongue, Reverse 7098 zinc alloy lock body"
Door Thickness Available	40~65mm



MX SLIM Smart Lock

The MX SLIM smart lock stands out for its slim design with narrow escutcheons that give the door and the room a plus of style and elegance.

Its high technological level combined with the opening via Bluetooth, MiFare proximity card and remotely online, through Gateway, make MX SLIM one of the models with the greatest projection in the hotel sector.

- **DESIGN**
Slim profile escutcheon, with narrow and straight lines for a minimalist aesthetic. FINISHES: inox, black edition, White, gold, anti-bacterial
- **BLUETOOTH**
For guest openings, setting up, management and maintenance of the lock.
- **ON-LINE**
Remote zopening and management by including Gateways in the installation.
- **AH HOC**
Smart lock that adapts to existing mortise locks, even in narrow profile aluminum doors.

- **Unlocking record**
3360PCS
- **UNLIMITED AUDIT TRAIL**
Openings, opening attempts, exits, etc. Audit synchronized with the front desk PC.
- **CONTROL**
Installing in a room the MX SLIM lock, the KeySafe and the Gateway allows remote management and control of both devices. Compatible with the GUEST-PRESENCE security function of the KeySafe hotel safe control of both devices.

FEATURES

- Smart lock opening via Bluetooth and MiFare proximity.
- Option to open and manage online by installing Gateways.
- Escutcheon with adaptable handle, for doors of left or right opening.
- PVD (Phase Vapour Deposition) lacquered colors, with greater resistance to abrasion and corrosion.
- Guaranteed operation in the most adverse climatological environments. Stainless steel AISI 304 or AISI 316 manufactured.
- Electromechanical privacy function with exterior visual indicator to prevent entries of unauthorized persons.
- Hidden mechanical cylinder, for auditable emergency openings, and micro USB type C connector for power in case of depleted batteries. Both hidden and protected with a rubber cap.
- Visual and acoustic indicators to facilitate their use by disabled persons, as well as for additional functionalities such as low battery warnings to personnel, privacy indicator, etc..
- Single app for administrator, hotel staff and guests. UpKey allows different functionalities according to the registered user profile.
- The guest is automatically logged into the app via a link created by the hotel, which the guest receives in an email.
- Customized app option and integration with third parties.
- Operates with 4 standard AA batteries.





CLASSIC PRO Smart Lock

Hotel Smart Lock Classic Pro can be integrated with 16 public areas such as Lift, Parking, Swimming Pool

- **Material**
Stainless Steel, Moisture Proof, Fire Retardant
- **Working Voltage**
DC6V or 4 AA Alkaline batteries
- **Low Voltage Alarm**
<4.8V
- **Working Environment**
-20°C~60°C
- **Unlocking record**
3360PCS
- **Door Thickness**
32-70mm
- **Keycard Option**
Mifare 1 card
- **Size**
L290mm x W60mm x H15mm

FEATURES

- Interface with most of the PMS system, Fidelio/Opera registered
- CE & FCC Certified
- Stainless steel color lasts more than 10 years
- ANSI Standard mortise
- Inside Deadbolt, Inside handle retracts latches and deadbolt
- Mifare 1K card, compatible with Mifare Energy Saver
- Lost Guest Card suspension simply by issuing a new guest card with suspending function
- Multiple operators with different card issuing authorization
- Low battery voltage warning. (Lower than 4.8V).
- Self Error detecting with "Beep"
- Passage Model function available
- Can be integrated with 16 public areas such as Lift/Parking/Swimming Pool/Sauna Room/Tennis Court/Gym...etc

Superior Materials

304 Stainless steel, 2.0mm
304 Stainless steel panel and handles.
Lock Surface Color Enjoys 10 Years Warranty



800,000 Cycle Test

Passed American Military ANSI/BHMA A156
UL test more than 800,000





CLASSIC Electronic Locks

Solutions for hotels of all types

As a result of an ongoing R + D project, and its experience with locks, MICROAXS has 3 versions of a lock with the same design pattern as well as proximity, BLE and numeric code opening available for hotels.

FEATURES

- System of opening with MIFARE proximity card 13.56 Mhz, numerical code and via Bluetooth
- Anti-panic function to guarantee emergency exits
- Guaranteed operation in the most adverse climatological environments, thanks to its manufacture of stainless steel AISI 304 and its tropicalized electronics
- Visual and acoustic indicators to facilitate their use by disabled persons, as well as for additional functionalities such as low battery warnings to personnel, privacy indicator, etc.
- Electromechanical privacy function with exterior visual indicator to prevent entries of unauthorized persons
- Includes non-volatile EPROM which even when batteries are changed, allows the conservation of the last 400 openings, with information of user, date and time
- The Classic smart hotel lock has a hidden mechanical cylinder, for auditable emergency openings.
- Operates with 4 standard AA batteries with duration of up to 20,000 openings
- Configuration and auditing of the locks with wireless control unit
- Smart lock Free Turn with EURO mechanics as standard. ANSI mechanics available with fixed handle
- By installing Gateways, all devices equipped with Bluetooth become devices on-line, allowing remote management from the front desk pc or with a Smartphone
- Unlocking record: 3360PCS

Bluetooth Smart Lock for Hotel Classic BLE

The Classic BLE hotel smart lock model incorporates the Bluetooth opening as standard and all the features of the Classic smart hotel lock.

BLE lock features

- The guest is offered the choice to either access the room via Bluetooth using his phone or by using a proximity card.
- In the case the hotel wish to develop its own APP, Microaxs's API and SDK are available for developers.
- Upgrade Kit upgrades the hotel smart lock from only proximity openings to Bluetooth and Proximity openings.
- To install a net of gateways allows to the hotel to carry out the following common maintenance tasks:
 - Battery level checking
 - BLE and remote openings log audit
 - Remote opening/closing, controlled by security password

Upgrade kit for Bluetooth openings

Bluetooth module designed to upgrade CLASSIC and CLASSIC hotel smart locks to provide them with opening, maintenance and connectivity functions by Bluetooth.





MX-28 Smart Handle Lock

New smart lock, which will bring more convenience and safety to your life.

FEATURES

- System of opening with Smartphone via Bluetooth and MIFARE proximity.
- Option to open and manage online by installing Gateways.
- Hotel mode: Closed only from inside the room, using a knob or by reverse turning the handle.



Sturdy Metal design,
Anti-explosion and Anti-collision.

- (1) Made out of a zinc alloy.
- (2) Material for a safe design.



MX-15 Smart Glass Lock

New smart lock, which will bring more convenience and safety to your life.

FEATURES

- System of opening with Smartphone via Bluetooth and MIFARE proximity.
- Option to open and manage online by installing Gateways.
- Hotel mode: Closed only from inside the room, using a knob or by reverse turning the handle.



Suitable for
All Doors and Scenarios.

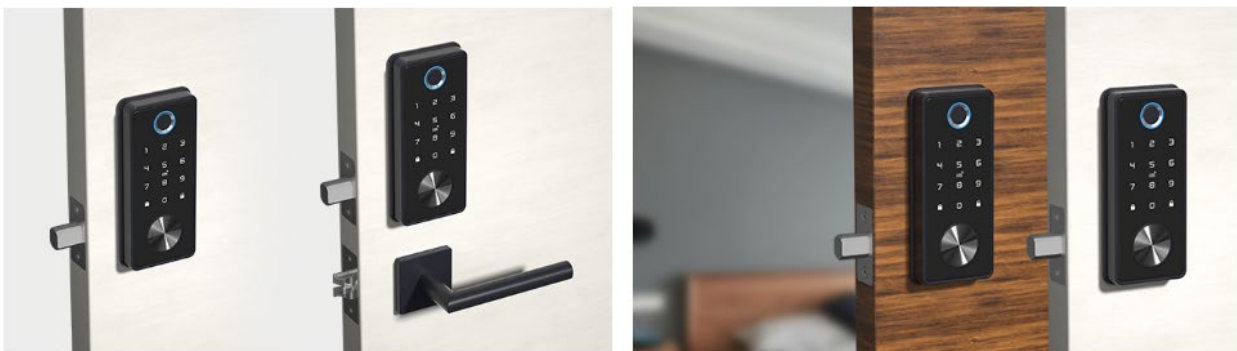



MX-SLK5B Smart Lock

MX-SLK5B smart lock has been designed to adapt to existing mortises and modernize doors, providing them with a comfortable and safe access control system.



MX-SLK5B Smart Lock

New smart lock, which will bring more convenience and safety to your life.

FEATURES

- System of opening with Smartphone via Bluetooth and MIFARE proximity.
- Option to open and manage online by installing Gateways.

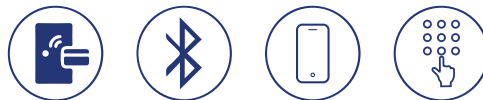

MX-SLK5B



MX-SLK5S



MX-SLK5G



MX-SLK5A





Gateway Online

The MicroaXs Gateway converts Bluetooth electronic locks and Bluetooth access controls into online devices.

With an online connection via Wi-Fi, the locks and access controls transfer the recorded events to the Cloud, through the Gateway, and devices can be managed remotely.

Online Functions

- Online Audit Trail
- Remote opening from Reception or via administrator smartphone
- Battery level control
- Access credential management
- Date / Time Update
- Opening alerts

Operation

The online MicroXs system operates by double connectivity: Bluetooth and Wi-Fi.

Devices → Administrator

Electronic locks and access controls send the information via Bluetooth to the Gateway. The Gateway, connected to a hotel Wi-Fi network, sends all the information received to the server to make it available for the administrator.

Administrator → Devices

The Online functions the administrator executes remotely from their PC or Smartphone are transmitted from the server to the Gateway via Wi-Fi, and channeled via Bluetooth to the locks and access controls. When the administrator Smartphone and the lock or access control to be managed are within the Bluetooth range, they communicate directly via Bluetooth and transmit the information without using the Gateway or Wi-Fi.

To implement an Online system, a Wi-Fi network, locks and/or access controls with Bluetooth connectivity from Microaxs are essential.

Features

- Bluetooth range: up to 10m
- Network: 2.4G Wi-Fi
- EEE standard: 802.11 b/g/n
- Connection: USB Type C
- Power: 5V/500mA DC
- Dimensions: 70 x 104 x 18 mm

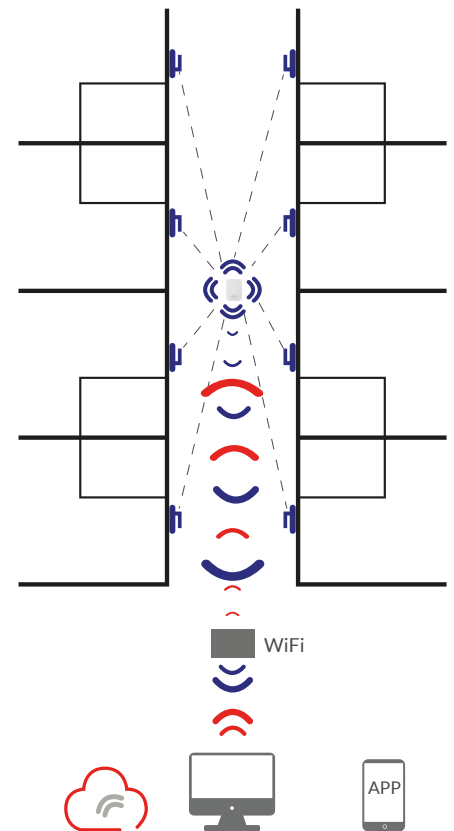

Compatibility

The Gateway is compatible with all MicroXs Bluetooth locks, access controls and safes.



BLE



INOVO



MX-HL11



CLASSIC FIT



MX SLIM



MX-28

locks For Lockers



E-LOCKER MIFARE PLUS

Simple and fast installation in lockers and cabinets made from wood, sheet metal, plastic, phenolic, etc., thanks to its standard Euro size.

Discreet design, adaptable to doors with a thickness of up to 30mm.

2 different modes of operation:

- Owner: for lockers exclusively used by one person
- Allocation: the user uses the free lockers that are available at any given time

Management system with its own software.

Electronic Lock for Locker Smart

Locker mode: The lock is normally open and closes/opens when it reads a card with valid authorization.

Drawer/Furniture mode: The lock is normally closed and opens if it reads a card with valid authorization. The latch closes after the programmed time.

Simple and quick installation in lockers and cabinets made of wood, sheet metal, plastic or phenolic plastic, for example, due to their standard Euro size.

Discreet design without knob, hidden inside the furniture.

Opening by proximity RFID.



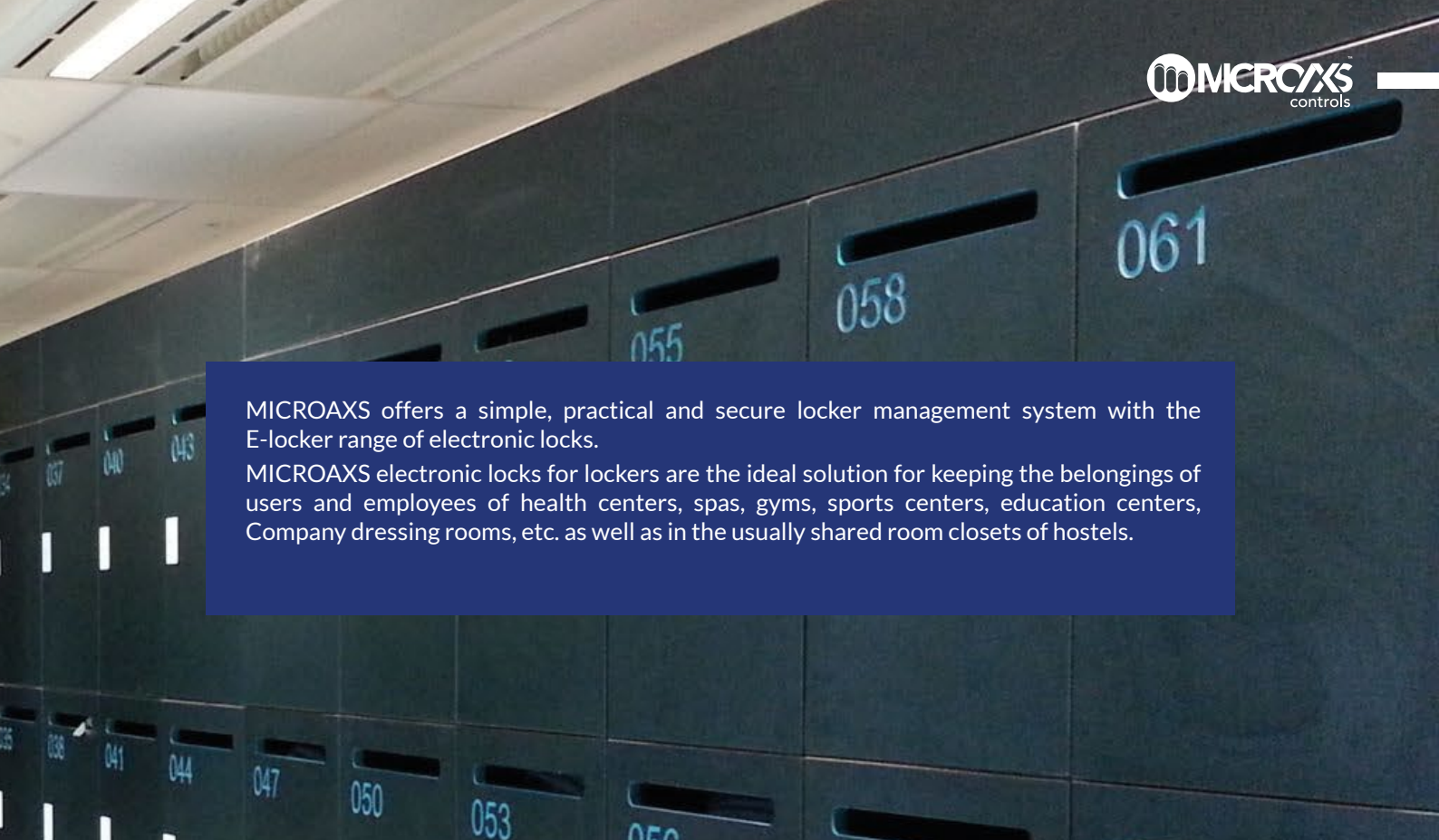

MICROAXS offers a simple, practical and secure locker management system with the E-locker range of electronic locks.

MICROAXS electronic locks for lockers are the ideal solution for keeping the belongings of users and employees of health centers, spas, gyms, sports centers, education centers, Company dressing rooms, etc. as well as in the usually shared room closets of hostels.

E-LOCKER STYLE MIFARE

Integration with MICROAXS locks, the same MiFare card for the room and the locker.

Fast installation in lockers and cabinets made from wood, sheet metal, plastic, phenolic, etc.

Modern, easy and intuitive design for the user. Integrated handle for easier use of the locker.

Allocation: the user uses the free lockers that are available at any given time



E-LOCKER STYLE KEYPAD

Easy management without cards; operates by code.

Possibility of opening with MiFare Card to simplify its use by employees.

Fast installation in lockers and cabinets made from wood, sheet metal, plastic, phenolic, etc. Integrated handle for easier use of the locker.

Allocation: The code is recorded on closing and is deleted after opening. The user uses the free lockers that are available at any given time

Electronic Lock for Lockers Lockerfy

Simple and fast installation in lockers, cabinets, drawers, etc. Suitable for installation on all types of materials.

Opening modes:

- BLE (Bluetooth Low Energy): with APP mobile.
- Online: remote opening through Gateway.
- Emergency: administrator master code for emergency openings.

With optional keyboard:

- Numerical code: permanent, temporary, cyclic and one time access.
- MiFare proximity.





BOH Access



Lift Access Control

With the lift control, the guest can only access where you have granted him permissions.

With the pertinent credentials on the card, the hotel will be able to limit the general use of the lift or even limit access to specific floors. The system operates off-line and makes it possible to increase the security level of the hotel.

Bluetooth Access Control Digit

Access control with opening by numeric keypad, Bluetooth, proximity card or on-line. Designed to control doors and external access to buildings, garages, etc. and to common areas of hotels and offices. Possibility of providing them with online functionalities to increase user security and control.

Two models differentiated by their opening modes:

- Proximity card, Bluetooth and on-line, connected via Gateway.
- PIN code, proximity card, Bluetooth and on-line, connected via Gateway.

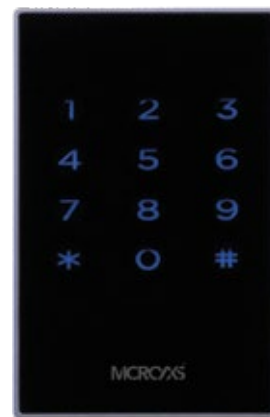

Access Control MINI

With a sophisticated and discreet design, the MINI access control is the ideal solution for those common areas of the hotel, special or restricted, where the installation of an electronic lock is not possible.

Access control designed for indoor or outdoor use in hotels and buildings, in access to common areas such as:

- Lift.
- Spa / Gym.
- Restaurant.
- Conference room.
- Hotel entrances (reception).



www.microaxs.com



USA & CANADA

Tel +1-877-677-4040
info@microaxs.com
Williams Tower, 41st Floor, 2800 Post
Oak Boulevard, Houston, TX 77056, USA

UK

Tel +44-203-835-2255
uk@microaxs.com
86-90 Paul Street, London, England,
United Kingdom, CE2A 4NE

MENA

Tel +971-4-556-1557
mena@microaxs.com
Boulevard Plaza Tower One, Level 3,
Downtown Dubai, United Arab Emirates